



***ELECTRIC WINE BOTTLE OPENER***



***OWNER'S MANUAL***  
***BO60***

Visit our web site at [www.emersonradio.com](http://www.emersonradio.com)

EMERSON

PART NO.: BO60-05222007-02

Printed in China

UNAUTHORIZED MODIFICATIONS TO THIS DEVICE COULD VOID  
THE USER'S AUTHORITY TO OPERATE IT.

## PLEASE NOTE THESE IMPORTANT SAFETY POINTS

**WARNING. When using this electrical appliance the following safety precautions should be taken to reduce the risk of fire, electric shock and personal injury.**

- Read all the instructions before use and save them for future reference.
- When using or recharging the corkscrew keep your work surface clean and free from potential hazards.
- Never use the corkscrew in damp areas or near water, sinks or taps.
- Never submerge the corkscrew or charger.
- For indoor use only. Do not expose the corkscrew or charging unit to rain or other extreme conditions.
- Never force the corkscrew onto a bottle or attempt to speed up the mechanism. The corkscrew will work best when it is operated at its intended speed.
- Do not touch or adjust the corkscrew's mechanism or the corkscrew spiral. Only hold the corkscrew by the plastic housing.
- Do not attempt to open bottles if the switch is not working correctly.
- Keep away from children. This is not a toy.
- Do not attempt to open the corkscrew or the recharging unit. It has no serviceable parts. In event of malfunction in this time please contact our customer services department .
- Do not attempt to operate if the corkscrew, cord, plug or recharging unit is damaged, dropped or malfunctions.
- Only recharge the corkscrew using the recharging unit and power cord supplied.
- Never remove the plug from the socket by pulling the power cord.

We recommend that you charge your corkscrew for at least 16 hours before using it for the first time. Please follow the instructions for recharging below:

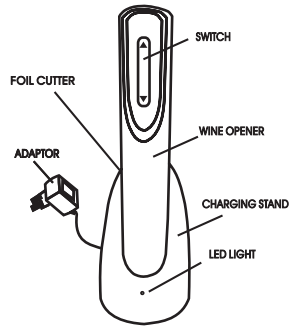

### Recharging your corkscrew

Plug one end of the adaptor cord into the base of the recharging unit and the other end into a main socket. Place the corkscrew into recharging unit, ensuring that it is firmly in position and is fully engaged with the recharging connectors. It will take approximately 12 hours to recharge your corkscrew. When the corkscrew is fully recharged it can be used to open approximately 30 bottles.

### How to operate the corkscrew

Before using the corkscrew, you must remove any foil from the top of the bottle using the foil cutter provided.

The corkscrew is operated by a one simple switch. The switch has two functions.

Press the lower part of the switch to remove a cork from a bottle. Press the upper part of the switch to release a cork from the mechanism after you have removed it from the bottle. (See Pic 1)

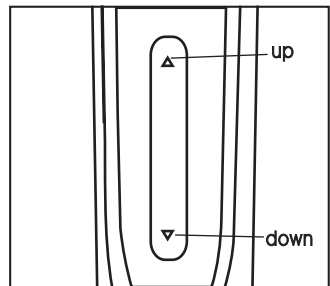

(Pic.1)

## LIMITED WARRANTY

Emerson radio Corp. warrants manufacturing defects in original material, including original parts and workmanship, under normal use and conditions, for a period of ninety(90) days from the date of original purchase in the U.S. With your dated proof of purchase, We will provide repair service at no charge for labor and parts (excluding battery)at an authorized Depot Repair Facility, or replace the product in our discretion.

For repair or replacement, pack your unit in a padded box, enclose your check or money order payable to Emerson Radio Corp. in the amount of \$5.00(not required by California residents)to cover shipping and handling costs, and enclose a copy of your proof of purchase. Send your unit to:

**Emerson Radio Corp.,  
5101 Statesman Drive,  
Irving, TX 75063**

This warranty does not cover damage from negligence, misuse, abuse, accident, failure to follow operating instructions, commercial use, rental, repairs by an unauthorized facility, or products purchased, used, serviced or damaged outside of the United States.

**THIS WARRANTY GIVES YOU SPECIFIC LEGAL RIGHTS, AND YOU MAY ALSO HAVE OTHER RIGHTS WHICH VARY FROM STATE TO STATE.**

AU898P

The serial number of your system is located on a label on the bottom cabinet. Please take a moment now to locate the serial number and write the number in the space provided below. You may be asked to provide this number when calling for product service.

Model Number:

Serial Number: \_\_\_\_\_

- Batteries may not be disposed of in municipal waste.
- Recycle or dispose in an environmentally sound manner.
- Laws in most areas prohibit the incineration, land filling, or mixing of nickel-cadmium batteries with municipal solid waste.
- Return batteries to a federal or state approved nickel-cadmium battery recycling center. Contact your local waste management officials for other information regarding the environmentally sound collection, recycling and disposal of batteries.



For further assistance or proper disposal, please call 1-800-8-BATTERY OR 1-800-530-4508

 <b>Emerson</b> SERVICE	TO FIND THE LOCATION AND PHONE NUMBER OF YOUR NEAREST SERVICE CENTER PERMITTED TO PERFORM WARRANTY
CALL TOLL FREE: 1-800-695-0098	

<b>FOR ADDITIONAL SET-UP OPERATING ASSISTANCE          PLEASE CALL: 1-800-898-9020</b>
--

<b>FOR CUSTOMER SERVICE, PLEASE WRITE TO:</b> Emerson Radio Corp., Consumer affairs Dept., 5101 Statesman Drive, Irving, Tx75063.
---

1. Place the corkscrew on the top of the wine bottle. Ensure that it remains as upright as possible at all the times. If you hold the corkscrew at an angle to the bottle, it will not remove the cork properly. (See Pic 2).

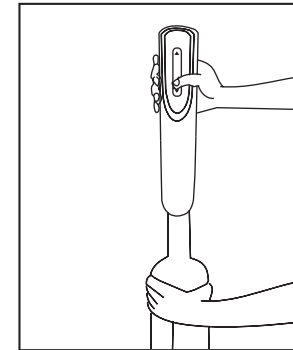

(Pic.2)

2. Hold the corkscrew firmly and depress the lower part of the switch. The corkscrew spiral will turn in a clockwise direction and enter the cork, then gradually remove it from the bottle. When the corkscrew mechanism stops, the cork has been fully removed from the bottle.
3. Lift the corkscrew away from the bottle.

To remove the cork from corkscrew, hold the cork firmly and depress the upper part of the switch. The spiral will turn in an anti-clockwise direction and release the cork. (See Pic 3).

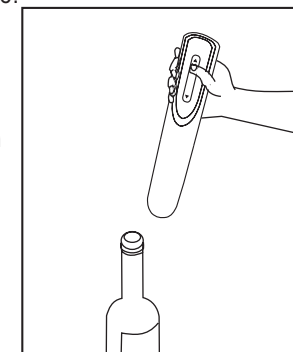

(Pic.3)

4. Always return the corkscrew to the recharging unit when you have finished with it. This will protect the mechanism while it is not in use. Note-It has been note d the automatic corks crew may experience problems with a small percentage of plastic/synthetic corks and undersized corks, if in this case the cork should be removed manually.

## REMOVING THE RECHARGEABLE BATTERIES

Your bottle opener is equipped with nickel-cadmium (Ni-Cad) batteries. If they are defective or dead, or the unit comes to the end of its useful life, remove the rechargeable batteries as described below for environmentally safe disposal.

1. The 6 screws can be twisted by pressing against the unit back house and twisting the handle in a counter-clockwise direction.

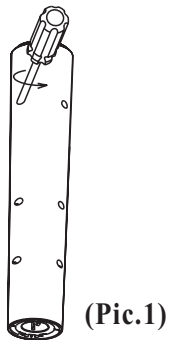

2. Once loose, You can open the expose unit back housing and the battery.

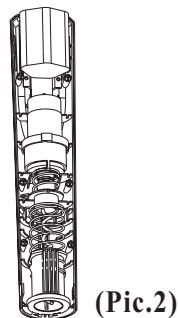

3. Pull the battery out of the compartment.

Using a common household tool, such as scissors or wire cutters, carefully cut through the wires attached to each end of the battery. The battery is now free for correct disposal.

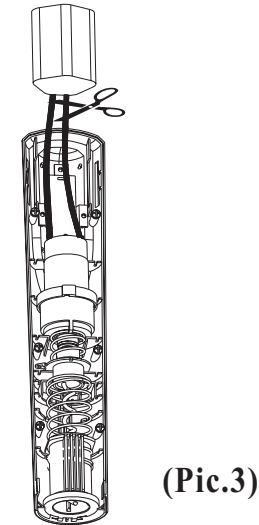

## ENVIRONMENTAL NOTICE - NICKEL-CADMIUM BATTERY

This product contains a nickel-cadmium (Ni-Cad) battery that must be recycled or disposed of properly.